

# NORTH WING: GROUND FLOOR

NORTH WING	DIMENSION Length x Width x Height	AREA m <sup>2</sup>								
			THEATRE (Persons)	BANQUET (Persons)	RECEPTION (Persons)	CLASSROOM (Persons)	HOLLOW SQUARE (Persons)	U-SHAPE (Persons)	BOARDROOM (Persons)	EXHIBITION (Booths)
Etoile	30 x 16 x 6.05	480	350	350	250	100	40	40	20	-

GROUND FLOOR (NORTH WING)

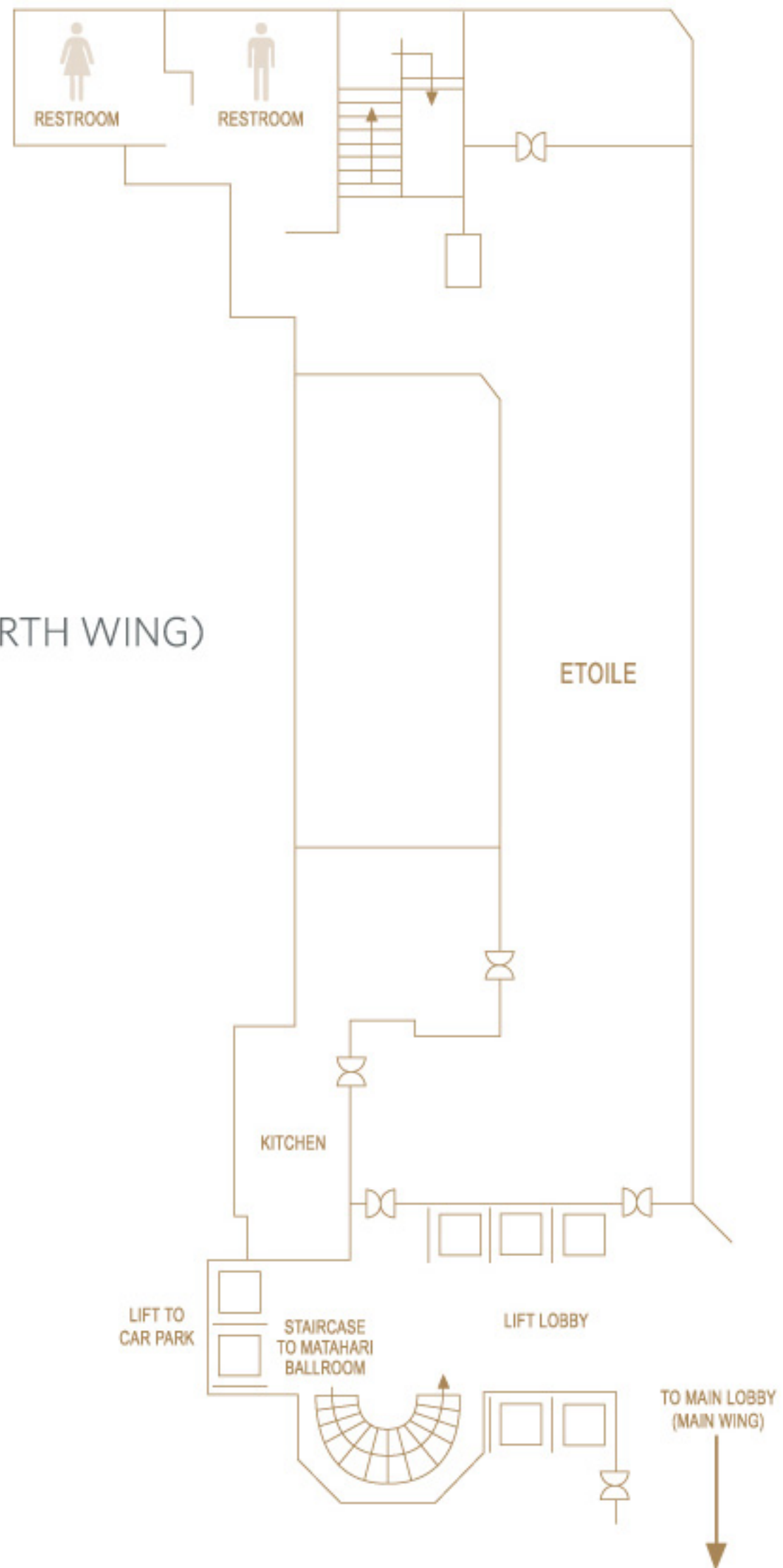

# GROUND FLOOR (NORTH WING)

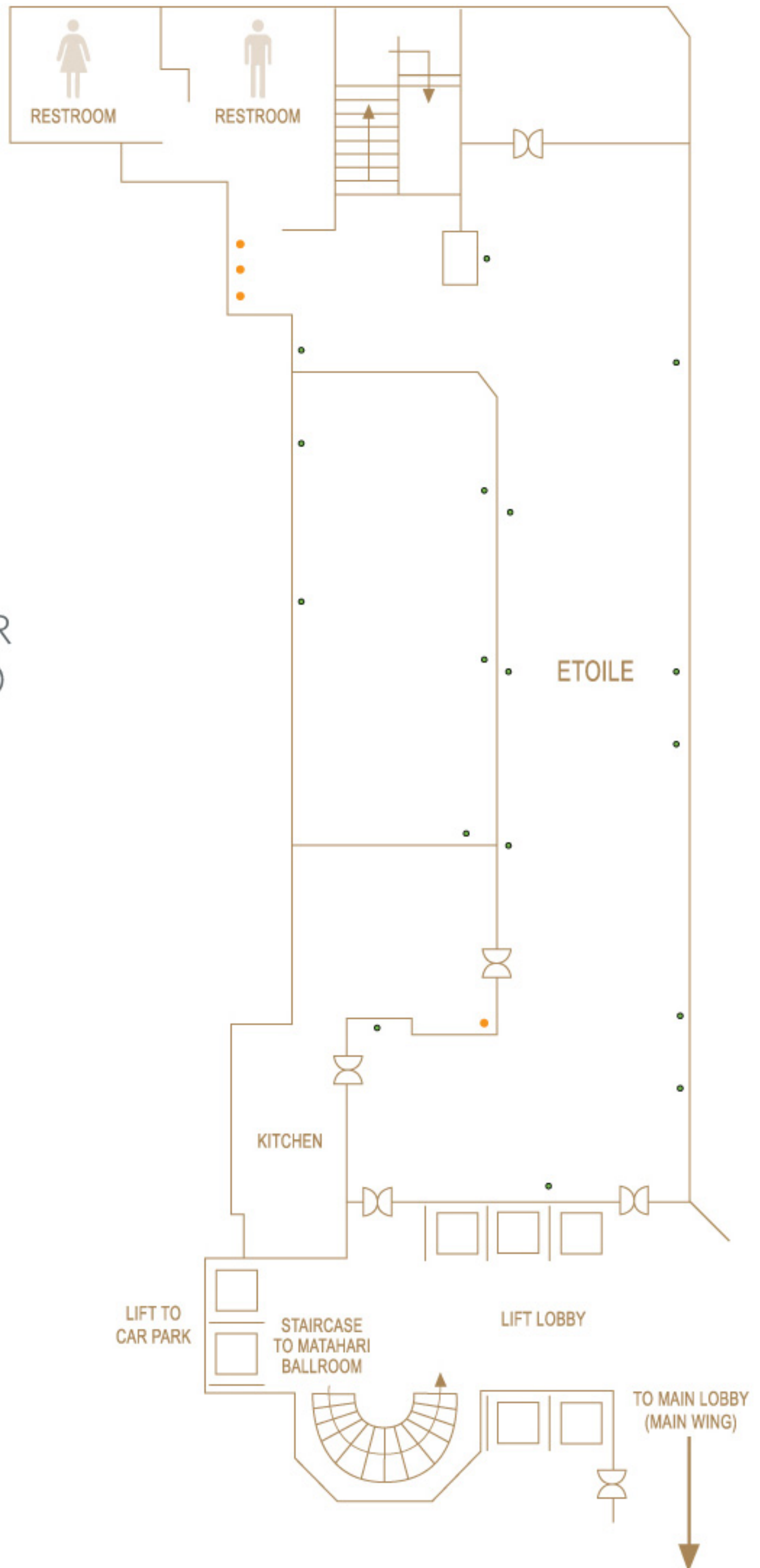

- Telephone
- Internet
- Power Point
- 3 Phase